

# Bent School Newsletter



# SUPERSTAR GAZETTE

Bloomington Public Schools District 87

## Table of Contents

- [Message from the Principal](#)
- [PTO News](#)
- [Notes from the Cafeteria](#)
- [Nurse Notes](#)
- [Library News](#)
- [October 2020 Calendar](#)

## Message from the Principal

Dear Bent Superstar Families,

I know we are all surprised at how fast September has flown by!

We have certainly had a very different month...it has been incredibly busy, and we have had to learn so much about technology in such a short amount of time. It sure is wonderful to see everyone back in school, even if at a distance. I am so grateful to all of our staff, students and families for all the collaboration and support you have given each other during this challenging beginning of the school year. It is true that "TOGETHER, WE ARE BETTER!" By now, everyone is better at navigating the remote learning environment, new routines and getting down to the business of learning. This year has so much in store; our entire team is excited to witness their growth!

Parent/Teacher Conferences are rapidly approaching. If you have not scheduled a conference with your child's teacher, I highly encourage you to do so. Parents are a vital part of the education process! Most teachers are making themselves available in the evening during the week prior to the actual P/T Conference day to accommodate as many parents as possible (Oct. 5-9).

Please continue to use REMIND, email, and phone calls as your method of communication with teachers. If your email or phone number changes, please communicate that with the office. If you continue to experience issues with technology, reach out to us by calling our office at 828-4315, and we will help you.

I would like to put a plug in for the Bent PTO. This small group of dedicated parents is very valuable with all their support of Bent's students and teachers. I would like to encourage all Bent parents to attend a PTO meeting to provide your valuable input.

Do not forget to follow our Facebook page at <https://www.facebook.com/BentElementary>. We will be updating our page weekly.

As always, thanks for your support!!

Sincerely,

Mrs. Delgado

**Principal**

Mr. Jeff Geringer

**Address**

Bent School  
904 N. Roosevelt  
Bloomington, IL 61704

**Phone**

309-828-4315

**Fax**

309-828-3587

## PTO News



Thanks to all who joined the PTO's first Zoom meeting on September 15<sup>th</sup>. We are excited for what this year will bring.

PTO elected officers for the 2020-2021 school year!

The new board members are:

President – Marie Streenz

Vice President – Andrea Fallat

Treasurer – Nick Johnston

Secretary – Laine Twanow

### Upcoming Fundraisers

Online catalog – October 5<sup>th</sup> – 16<sup>th</sup>. Look for the fundraising information letter via the school Remind App and the Bent School Parents' Facebook page. All orders will be online and shipped directly to the person ordering. No more needing to pass out items!

Chipotle Restaurant Night – November 24<sup>th</sup> 5-9pm @ the Chipotle on Main Street near Hovey Ave. Flyers to be posted on the Bent School Parents' Facebook page and via the Remind App.

Parent's Night out – December 11<sup>th</sup> 6-10pm @ Coffrin's Martial Arts. \$15 per child 5 and up only. Kids will have crafts, games, and activities. You can also opt in for Pizza, drink and a cookie for an additional \$6. Coffrin's is located at 2601 GE Rd, Bloomington near the intersection of GE and Airport Rd. This is a great opportunity to get some shopping or wrapping done for the holidays or just grab some peace and quiet.

### Spirit Wear

Fall Spirit wear order forms will be coming out by mid-October. Some new items this year that we are looking into are: quarter zip hoodies, polo shirts, beanies, and masks. Have something you would like to see? Post it on the Bent School Parents' Facebook page.

### Community Scavenger Hunt

Some fun for fall! PTO is working with Teachers to put together a fun and educational community scavenger hunt event Downtown Bloomington on October 2nd. It will run during the monthly First Friday's event, and students will be given various clues to find certain things or places Downtown. They will take a selfie in that area and submit their selfies for a fun prize. More info to come on this through Remind and Bent School Parents' Facebook page.

### Box Tops

Do not forget to download the Box Tops app on your smartphone. Box Tops is now almost all virtual, and you need to scan your receipt with this app which will give box tops credit to Bent. There are also special bonus box tops monthly that are listed on the app, which really add up! Please reach out to PTO if you have any questions.

### Volunteer opportunities

We will post about volunteer opportunities on the Facebook page as well as through the school Remind system. Currently, the project for the scavenger hunt is looking for help to organize the clues and place those clues. If you have ideas, please let us know.

Any other questions, suggestions, thoughts, or anything else you would like to bring up with the PTO, just drop us a line. The Facebook page is monitored throughout the day every day, and we will get back to you ASAP.

We are looking forward to a great year!

## Notes from the Cafeteria



Remote Meals are FREE for EVERYONE 18 and under!

You no longer need to place an order to pick up meals!

Pick-up locations and procedures:

### How to receive meals during remote learning

Meals will be distributed from designated locations on Tuesdays and Thursdays. A D87 food service employee on site will ask how many children are requesting meals.

#### The pick up times and locations are:

- Bent Elementary School 11:30 - 12:45
- Oakland Elementary School 11:30 - 12:45
- Washington Elementary School 11:30 - 12:45
- Bloomington Junior High School front entrance 12:00 - 1:00
- Irving Elementary School 11:30 - 1:30
- Sheridan Elementary School 11:30 - 1:30
- Stevenson Elementary School 11:30 - 1:30
- Bloomington High School, north parking lot 11:30 - 1:30
- Friendship Park at Allin/Jefferson - 11:30 - 1:00
- Wood Hill Family Homes 1:00 - 1:30
- Sunnyside Park 1:00 - 1:30
- Arbors at Eastland by the pool 1:00 - 1:30
- 11:30-12:00 at Evergreen Park (corner of Morris & Forrest)
- 12:15-12:45 at Holton Homes (corner of Monroe & Holton)
- Also, the stop at Friendship Park is now from 1-1:30.

Distribution reminders:

Generally, two breakfasts and two lunches per student will be available to pick-up on Tuesdays. Generally, three breakfasts and three lunches per student will be available for Thursday pick-up.

- Children do not need to be present for a guardian to pick up meals.

- Anyone feeling ill or **experiencing COVID-19 symptoms** should not attend the meal pick-up.
- Please wear a mask and maintain a 6-foot distance between other families as much as possible during meal pick-up.

## Nurse News



If you have not already turned in a Kindergarten school physical and immunization record, please turn them in by Oct. 15th! Kindergartners are also required to have a vision exam with an eye doctor which is due Oct 15<sup>th</sup>, and a dental exam which is due May 15<sup>th</sup>. Even during this time of remote learning, the State of Illinois is still requiring students to have these turned in.

Students who are coming from out of state have 30 days from the time of enrollment to turn in an Illinois school physical with a completed immunization record along with a vision exam.

Please let me know if you have any questions or concerns, and I will help in any way I can.

My E-mail is [Rutherfords@district87.org](mailto:Rutherfords@district87.org)  
ph. 309-828-4315 ext. 1207

## Library News



Please use clean hands when using your laptop, and keep food and drink away from them. Food crumbs can get in your keyboard and cause it not to work right, and food that gets stuck under your laptop will slow it down. Plus, it is easier to see your screen when everything is clean. Thank you for helping protect your laptop!

# Laptop Troubleshooting Guide

ISSUE	SUGGESTIONS
<p>"Internet connection unstable" message pops up.</p> <p>The computer screen freezes or the video stream is choppy.</p> <p>You are kicked out of the Zoom meeting.</p>	<p>This is likely due to your internet provider.</p> <p>If you are using a hotspot, make sure you are clicked on the correct wifi "BPS--xxxxxx" and make sure the hot spot is powered on and plugged in.</p> <p>If you are using home wifi check to make sure you are on the correct network.</p>
<p>The sound stops working.</p>	<p>This could be because of your earbuds/headphones. Try unplugging your audio connection and plugging back in. Check the "mute sound" icon at the bottom of your screen in the Windows notification area (by the clock). Also, check the headphone cords are intact. Sometimes, students chew on the wires and this can interfere with the function. You can also close all programs and re-start the computer. If this does not work, contact your teacher.</p>
<p>The video stops working.</p>	<p>This is likely an error with your laptop's camera feature. Try closing all programs and re-starting the computer. If this does not work, contact your teacher.</p> <p>If the video turns to a "green screen", re-start.</p>
<p>The charger is not working.</p> <p>The device will not power on.</p>	<p>Double check the charger brand matches the laptop brand (Dell or HP). Make sure all parts of the charger are completely plugged in. Try a different outlet, and let the device sit for at least 30 minutes. If this does not work, contact your teacher.</p> <p>Press the power firmly to ensure it worked.</p> <p>Some devices will ONLY work when plugged in.</p> <p>Also, some devices go idle if left unattended. The device is still working so press the POWER button to wake it up.</p>

Common issues with HP Device (these are the ones that are silver on inside and say HP on black cover)

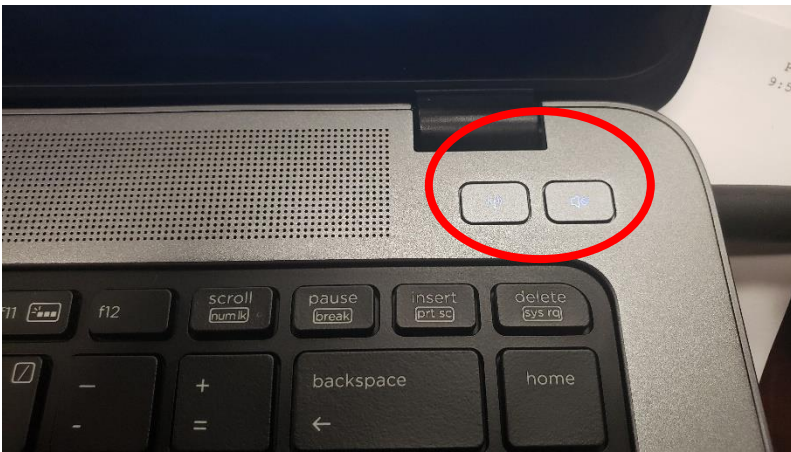

These 2 buttons on far right top keyboard  
-the one on left turns OFF wifi  
- the one on rights turns OFF sound



If they bump f6 they will lose their volume. Press f7 to fix.

If they bump f8 they will lose their microphone.

For f8 and microphone, the sound icon will show GRAY= NOT WORKING

To get it to work, they need to click on that gray icon for sound and turn it up.

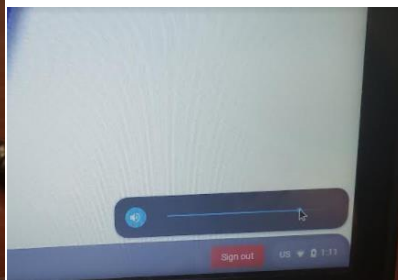
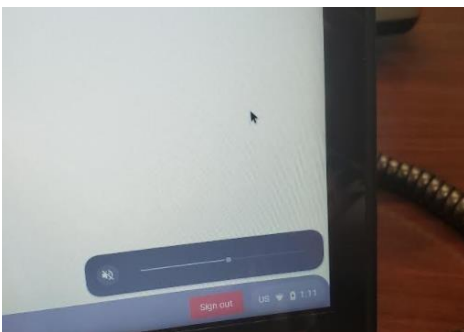

**= GOOD**

You want the sound icon to show BLUE= working

If your wifi goes out on a DELL laptop, press Fn key (left side of keyboard) and PrtScr (top right of keyboard)

Other helpful ideas: Please charge your device!!!!  
 Make sure the cord is plugged into both the laptop and the wall outlet. Some devices will only work when plugged in.

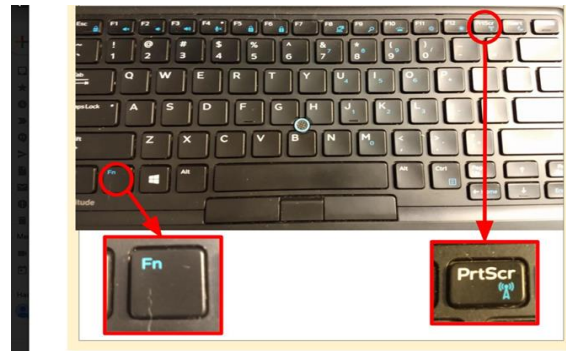

### Bent October 2020 Calendar



# October 2020

---

At Bent Elementary School

Sunday	Monday	Tuesday	Wednesday	Thursday	Friday	Saturday
				1	2 Bent Spirit Day 4:30-6:00 pm Bent Family Scavenger Hunt in Downtown Bloomington	3
4	5 Online Catalog	6 Online Catalog  3:15 -ISU Mentors	7 Online Catalog	8 Online Catalog	9  Online Catalog Parent Teacher Conference  No School	10
11	12 Online Catalog  Columbus Day No School	13 Online Catalog  3:15 -ISU Mentors	14 Online Catalog	15 Online Catalog	16 Online Catalog	17
18	19	20  3:15 -ISU Mentors	21	22	23	24
25	26	27 3:15 -ISU Mentors	28	29	30	31